

RSD SERIES RESIDUE DEWATERING PUMP



*FEATURES

- 1. Light weight, easy carry and high efficiency(Dry weight only 9.5Kgs)**
Extremely light and easy carry, Double frame casing, Outer cover made of stainless steel best performed silicon mechanical seal for excellent sealing. Circumferential flow system assures superior cooling effect. Long lasting durability. For long continuous running.
- 2. Powerful Suction.** Epoch-making design of bottom strainer enables to suction residue water max. Up to 2mm in height from ground.
- 3. Never leaking any water once sucked.**
Equipped with typical swing check valve and valve sheet at suction side. So, water once sucked, never return even if pump stops.
- 4. Never damage surface of pit.**
As bottom plate comes with the cushion rubber, no damage surface of pit even if it's made of fiberglass reinforced plastics.

*APPLICATIONS

- Pumping out of residue water from receiving tank and pumping pit.
- Drainage of bottom water in construction sites, underpasses and underground pits.
- Removing residue water in pit and ditch.
- Pumping water out of swimming pools.

*CAUTIONS

Be sure to provide an adequate grounding and install the leakage circuit breaker before use without fail.

Stainless Steel Casing
Equipped with
Epoch-making
Swing check valve

Model	Motor Output		Discharge Bore		Max-Lift		Voltage 1 Phase 50 or 60Hz	Cable c x mm x m	Dimension(mm) L x W x H	Weight	
	HP	KW	Inch	mm	ft	m				Lbs	Kgs
RSD-400	1/2	0.4	1	25	36	11	100-120V 200-240V	3x1.25x6	370x167x167	21	9.5

WE RESERVE THE RIGHT TO ALTER SPECIFICATION OR DESIGN WITHOUT NOTICE.

PARTS LIST

NO.	DESCRIPTION	NO.	DESCRIPTION	NO.	DESCRIPTION
001	STRAINER	13	MECHANICAL SEAL	26	UPPER COVER
001-2	BOTTOM PLATE	14	BEARING (BOTTOM)	26-1	ORING
001-3	SWING CHECK VALVE	16	MOTOR CASE	27	CABLE GLAND
001-4	RUBBER CUP	16	OUTER PUMP CASING	27-1	GASKET
03	SHAFT NUT	16-1	ORING	28	CABLE SLEEVE
05	IMPELLER	17	ROTOR SHAFT	31	CABLE
07	PUMP HOUSING	18	STATOR	34	HANDLE
07-1	ORING	24	BEARING (UPPER)	37	OIL
08	COVER OF OIL CHAMBER	21A	MOTOR BOTTOM COVER	38	DISCHARGE
08-1	GASKET	21A-1	ORING	38F	FLANGE
09	LIP SEAL	21B	MOTOR UPPER COVER	38F-1	ORING
10	SLEEVE	21B-1	ORING	38F-1W	OUTLET
11	PLUGS	2	CONDENSOR		

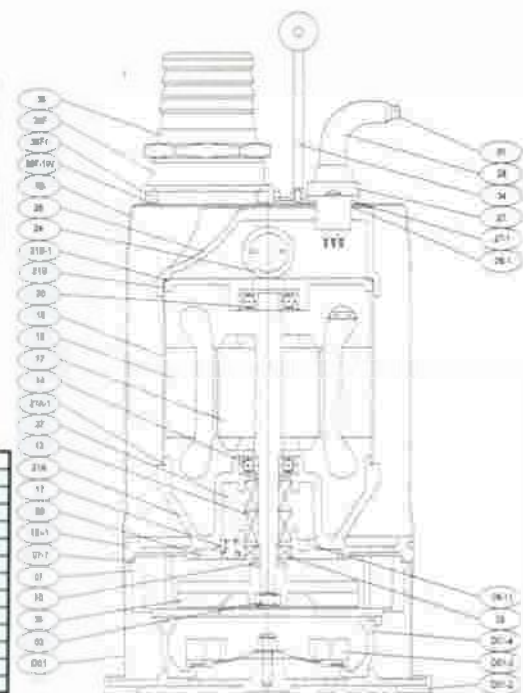

RS SERIES



RS400



RS100A

RS-250 RS-400

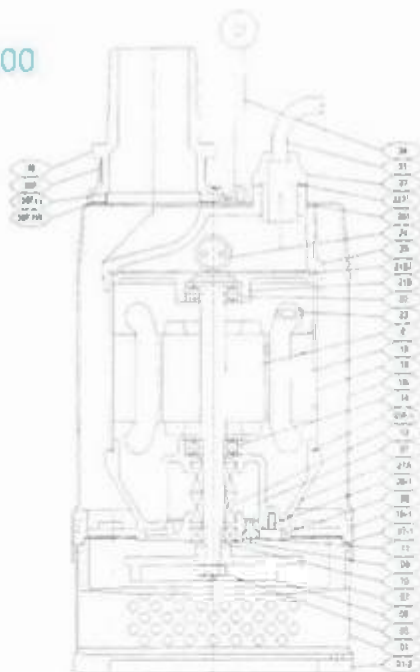

NO.	DESCRIPTION	NO.	DESCRIPTION	NO.	DESCRIPTION
01	STRAINER	16	MOTOR CASING	26-1	ORING
01-2	BOTTOM PLATE	161	OUTER PUMP CASING	27	CABLE GLAND
03	NUT	161-1	ORING	27-1	GASKET
05	IMPELLER	17	ROTOR SHAFT	28	CABLE SLEEVE
07	PUMP HOUSING	18	STATOR	31	CABLE
07-1	ORING	20	BRARING (UPPER)	34	HANDLE
08	COVER OF OIL CHAMBER	21A	MOTOR BOTTOM COVER	37	OIL
08-1	GASKET	21A-1	ORING	38	DISCHARGE
09	LIP SEAL	21B	MOTOR UPPER COVER	38F	FLANGE
10	SLEEVE	21B-1	ORING	38F-1	ORING
11	PLUGS	23	OVERLOAD PROTECTOR	38F-1W	OUTLET
13	MECHANICAL SEAL	24	CONDENSOR		
14	BEARING (BOTOM)	25	UPPER COVER		

RS100

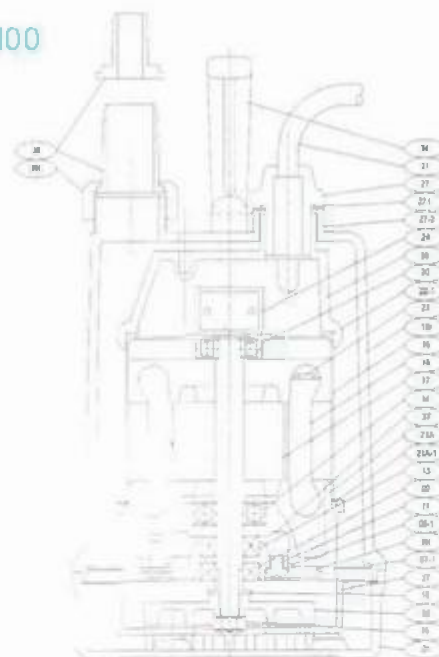

NO.	DESCRIPTION	NO.	DESCRIPTION	NO.	DESCRIPTION
01	STRAINER	14	BEARING (BOTTOM)	26-1	ORING
03	NUT	16	MOTOR CASING	27	CABLE GLAND
05	IMPELLER	161	OUTER MOTOR CASING	27-1	GASKET
07	PUMP HOUSING	17	ROTOR SHAFT	27-2	CABLE GLAND COVER
07-1	ORING	18	STATOR	31	CABLE
08	COVER OF OIL CHAMBER	20	BEARING (UPPER)	34	HANDLE
08-1	GASKET	21A	MOTOR BOTTOM COVER	37	OIL
09	LIP SEAL	21A-1	ORING	38	DISCHARGE OUTLET
10	SLEEVE	23	OVERLOAD PROTECTOR	38-1	GASKET
11	PLUGS	24	CONDENSOR	38L	LOCK NUT
13	MECHANICAL SEAL	25	UPPER COVER		

SUBMERSIBLE PUMP. MULTIPURPOSE

STAINLESS STEEL DOUBLE CASES

APPLICATIONS:

1. Garden pond recirculation & Aquarium use, Waterfalls, Fountains, Ornaments.
2. Horticulture Irrigation, washing.
3. Draining Bilge water.
4. Draining water from Basement & Garage.
5. Portable for All Purposes: Sea Water, Light chemical and Food industries.

- Latest designed double frame case for circumferential flow system assures superior cooling effect.
- Long lasting durability for long space continuous running.
- Rust-Proof, Acid-resistant suitable for sea water, light chemical & food industry.
- Light weight, Portable pump for various usage, in portable use and permanent installation to drain slightly waste water
- LATEST DESUGBED ELECTRONIC FLOATLESS LEVEL CONTROLLER for Automatic operation
- suitable for the permanent installation

CONSTRUCTION & MATERIALS

1. Pump Outer Casing: Stainless steel
2. Motor Housing, Suction plate, Bottom Screen, Shaft & all Screws: Stainless Steel.
3. Motor Cover & Pump Housing: Corrosion-Proof Cast iron.
4. Impeller: Fiber Re-inforced plastic.

*RS-400: Cast iron impeller suitable for handling sewage water

5. RS-400 Has Double Mechanical Seals:
General usage: Carbon Special application: Silicon.
6. Motor: with built-in Overload Protector.

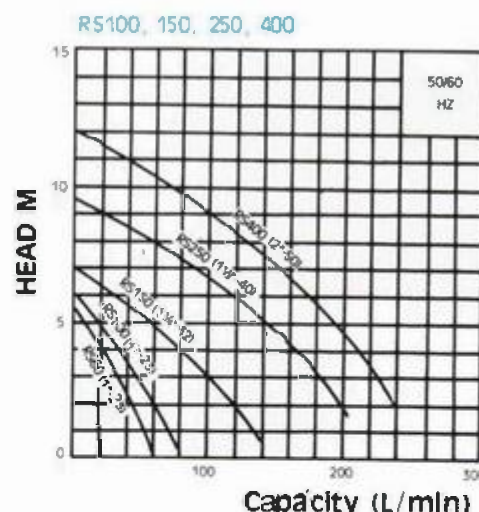

TECHNICAL DATA:

Pump Type	Outlet Diameter Inch (mm)	Output Watts	Voltage 1 Phase	Continuous		Maximum		Cable c x mm ² x m	Dimensions (mm) L x W x H	Weight Kgs	Auto
				Head m	Capacity L/min	Total Head m	max Capacity L/min				
RS-60	1(25)	60	50Hz or 60Hz 100/110/120V 100/240V 220/240V	3	40	5.5	65	3c x 0.75 x 3.5	237x 137x 137	3.90	RS-60A
RS-100	1(25)	100		3.5	45	6	80			4.1	RS-100A
RS-150	1 1/4(32)	150		4	80	8	140	3 x 0.75 x 6	370x 167x 167	12	RS-150A
RS-250	1 1/2(40)	250		6	110	9.5	220	3 x 1.0 x 6		13	RS-250A
RS-400	2(50)	400		7	130	12	250	3 x 1.0 x 6		14	RS-400A